

SPORTSMEN[®]

Travel Trailers

2017 Décor



French Roast



Linen

Standards

- New Aerodynamic Front Profile
- Diamond Plate Rock Guard on Front of Travel Trailers
- Enclosed Pin Box on FW's
- 3/8" Fully Walk-On Roof Decking
- 1-Piece Seamless Roof w/ SuperFlex[®] Roofing Material
- Awning w/Drip Rail & Spouts
- Tinted Windows
- Super-Sized Panoramic Slideroom Window
- Radius Entry Door
- Smooth Screwless Baggage Doors
- LED Pass-Through Storage Light
- Cable Hookup
- Digital TV Antenna w/Booster
- Self-Adjusting Electric Brakes
- Radial Tires
- Rear Bumper w/Sewer Hose Storage
- Winter Bypass Kit
- 2 or 4 Stabilizer Jacks (model specific)
- Outside Shower (N/A w/outside kitchen)
- (2) 20# Gas Bottles w/Bottle Cover
- 30 AMP Service
- 13,500 BTU A/C
- 3-Burner Cooktop
- Range Hood w/12V Light & Exhaust Fan
- Microwave w/Turntable
- Oven
- LP/Electric Double-Door Refrigerator
- Acrylic Sink w/High-Rise Faucet
- Solid Wood-Framed Mortise & Tenon Glazed Cabinet Doors

- Roller Ball Bearing Drawer Guides
- Decorative Light above Slideout Dinette
- Large Overhead Cabinets
- LED Interior Lighting
- Residential Crack-Resistant Congoleum[®] Linoleum Throughout
- Monitor Panel
- Built-In Medicine Cabinet w/Mirror in Bath
- Tub Surround
- Power Vent in Bath
- Skylight over Shower
- Queen Mattress
- Reversible Quilted Comforter
- Flush-Floor Bedroom (FW)
- Main Bedroom Roof Vent

K-Z Advantage Package (mandatory option)

- 2-Tone EXT Side Metal
- Nitrogen-Filled Tires
- Power Awning w/LED Light Strip
- 5/8" Tongue-&-Groove Plywood
- Key-Alike Program for Baggage & Entry Doors
- Bed Storage System
- Black Tank Flush
- 6-GAL LP/Electric DSI Water Heater
- Friction Hinge Entry Door
- Power Front Jack w/LED Light
- Large Folding Grab Handle
- Spare Tire
- Exterior Speakers
- Amber Step Light
- Solar Prep
- Backup Camera Prep

- Flip-Down 71" Storage Rack (N/A 362BH, 363FL)
- Alumi-Tread[®] Entry Steps
- Equa-Flex[®] Suspension
- Battery Disconnect
- ToyLok[®]
- Climate Package including Insulated/Heated/Enclosed Underbelly
- Push-Back Recliners (STD in lieu of barrel chairs)
- Seamless Countertops w/Under-Mount Kitchen Sink & Sink Covers
- Dinette Doors w/36" Pullout Storage Bins
- Upper Bunk Windows (select models)
- Drop-In Cooktop w/Glass Cover
- 8 CU FT Refrigerator w/Temp Controls
- Kitchen Skylight
- (2) LED Motion Sensor Lights
- Blue LED Light Strip above Slideout Room (main LR only)
- 12V Dual USB Port
- Jackknife Sofa w/Middle Console & Sofa Arms
- (2) 6.5" Interior Speakers
- Multi-Media Stereo w/DVD, Bluetooth & NFC Wireless Connectivity
- Foot-Flush Toilet
- Pleated Shades
- Queen Pillowtop Mattress
- Plywood Bed Base w/Gas Struts

Options

- Color-Infused Ivory Exterior Fiberglass (N/A 362BH, 363FL)

- 15,000 BTU A/C IPO
- 13,500 BTU A/C
- 2nd A/C (13,500 BTU)
- 50 AMP Service w/2nd A/C Prep
- 39" LED TV (N/A on 231RK)
- 32" LED TV (231RK only)
- Bedroom LED TV w/Inside/Outside Bracket
- Radiant Technology PKG (foil in floor, roof, front, rear)
- Freestanding Dinette Table & 4 Chairs IPO dinette (mandatory on 363FL)
- Tri-Fold Hide-a-Bed Sofa IPO Jackknife (mandatory on 362BH, 363FL, 333IK)
- Theater Seating IPO Jackknife (333BHK, mandatory on 333IK, 344BH)
- Plumbed for Washer/Dryer w/50 AMP (STD on 362BH, 363FL)
- Wardrobe Slide (261BH, 282IK, 301BHK)
- Front & Rear Electric Stabilizer Jacks (TT's only)
- Electric Rear Stabilizer Jacks (FW only)
- Fireplace (N/A 281RL, 231RK, 282IK, 322BHK)
- 16" Tires & Wheels (FW's only)
- Central Vac (FW's only)
- MaxxAir[®] Vent Fan in Living Room OR Bath
- Bunk Slide Trundle Bed IPO Dinette (312BHK, 323BHK, 333BHK, 301BHK)
- Wireless Backup Camera System
- Bumper-Mount Grill
- Roof Ladder

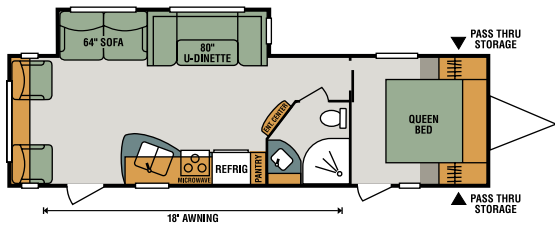

281RL

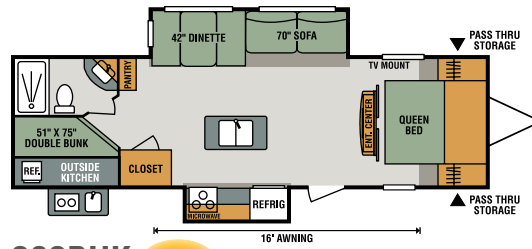

282BHK **NEW**

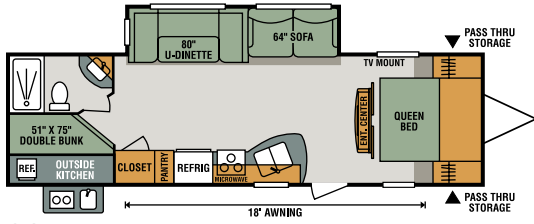

291BHK

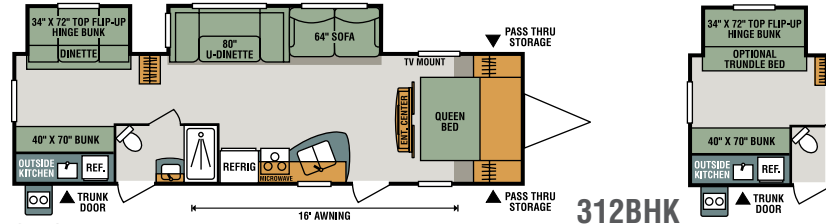

312BHK

312BHK Trundle Bed Option

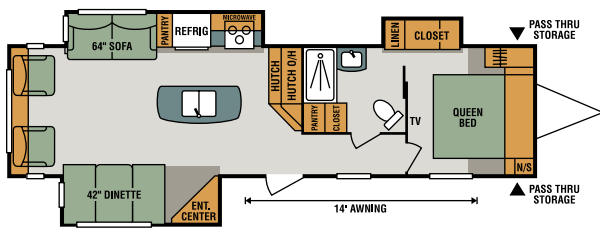

322IK

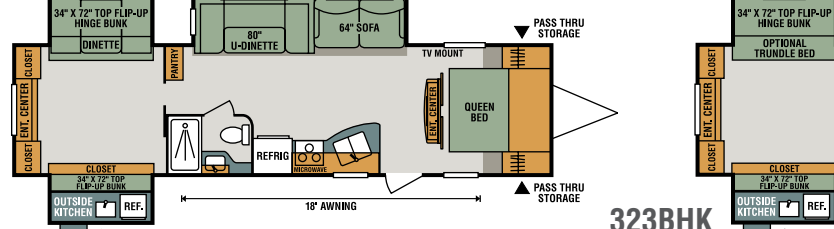

323BHK

323BHK Trundle Bed Option

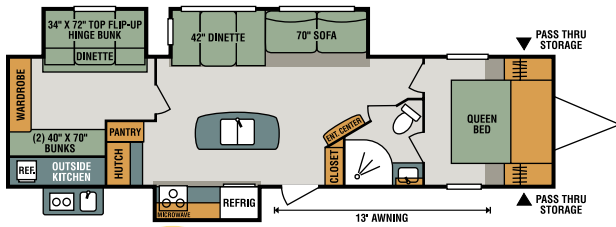

333BHK **NEW**

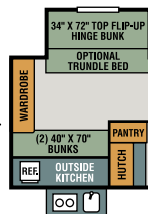

333BHK Trundle Bed Option

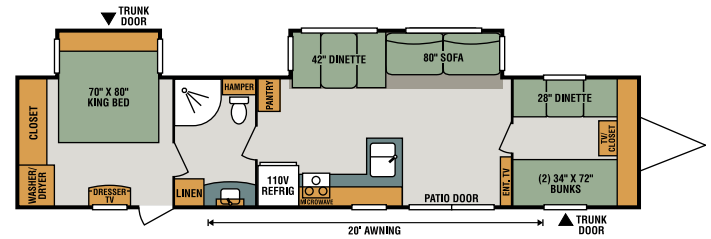

362BH

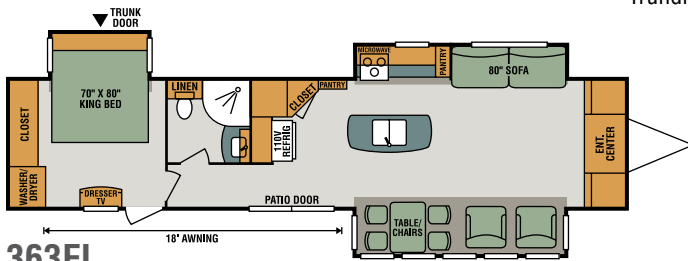

363FL



985 N 900 W • Shpshewana, IN 46565
E-mail kz@kz-rv.com • www.kz-rv.com

Due to continual research and advances, manufacturer reserves the right to change specifications, design, price and equipment without notice, and assumes no responsibility for any error in this literature. Some items shown are not included as standard or optional equipment. ©2016KZ | 9/9/16 | 2.5M

Travel Trailers	281RL	282BHK	291BHK	312BHK	322IK	323BHK	333BHK	362BH	363FL
UVW (Unloaded Vehicle Weight)*	6,260	6,080	6,280	7,060	7,690	7,680	8,520	8,150	8,910
Dry Hitch Weight*	790	840	760	600	890	700	950	1,150	1,460
Dry Axle Weight*	5,470	5,240	5,520	6,460	6,800	6,980	7,570	7,000	7,450
NCC (Net Carrying Capacity)	1,740	2,720	1,720	1,740	1,110	1,120	980	2,310	1,550
GVWR	8,000	8,800	8,000	8,800	8,800	8,800	9,995	10,460	10,460
Interior Height	82"	78"	82"	82"	82"	82"	82"	82"	82"
Exterior Height w/ A/C	11' 3"	10' 11"	11' 4"	11' 2"	10' 11"	11' 4"	TBD	11' 4"	11' 4"
Exterior Width	96"	96"	96"	96"	96"	96"	96"	96"	96"
Exterior Length	32' 1"	32' 8"	32' 3"	34' 4"	35' 4"	35' 11"	36' 8"	40' 9"	40' 9"
Refrigerator (cu. feet)	8	8	8	8	8	8	8	18	18
Water Heater Cap. (gal. G/E w/DSI)	6	6	6	6	6	6	6	6	6
Fresh Water Cap. (gal.)	38	40	38	38	38	38	38	38	38
Waste Water Cap. (gal.)	32	32	32	32	32	32	32	32	32
Gray Water Cap. (gal.)	32	32	32	32	32	32	64	64	64
LP Gas Cap. (lbs.)	60	40	60	60	60	60	60	60	60
Furnace BTUs (1,000s)	20	25	30	30	30	30	30	30	30
Tire Size	15"	15"	15"	15"	15"	15"	15"	15"	15"
Awning	18'	16'	18'	16'	14'	18'	13'	20'	18'

*This weight reflects the rolling average unit weight for each model. Your trailer weight will vary according to optional equipment.